

F2, F1600 **APPENDIX III**

## **Template Parts List**



© Leigh Industries Ltd. All rights reserved.

The purpose of this publication is to assist in the use of products produced by Leigh Industries Ltd. The procedures described in this publication are suggestions only. The user shall determine risk and assume responsibility for personal safety practices and application suitability, and is solely responsible for any consequences of following these guidelines.

This pdf version of this publication is intended as suggested usage procedures and may be downloaded and stored on a computer and printed, viewed, and freely distributed for operational guidance and evaluation purposes. This pdf file may comprise a chapter or portion of the full User Guide publication for the Leigh tool and may refer to and depend on information in other parts of the tool's User Guide for completeness. Any such downloading, storage, printing, viewing or distribution must maintain the complete pdf file of the User Guide chapter in its entirety and in its original form as downloaded. Except as provided herein, no part of this document may be reproduced, sold, published, distributed, modified, displayed, re-posted or otherwise used without the prior written permission of Leigh Industries Ltd. [revision date]

## F2 &amp; F2M PARTS LIST

For quick reference, record your  
template's serial number here.

When ordering parts, please quote the Template model (inch or metric), serial number, part number, part description and quantity required.

PART NUMBER	QUANTITY PER TEMPLATE	PART DESCRIPTION
3001	1	"Inch" Template with decals
3001M	1	"Metric" Template with decals
3011	1	"Inch" Template Bar with glides (3140)
3011M	1	"Metric" Template Bar with glides (3140)
3020	1	Fence with brackets (3030)
3030	2	Fence Brackets
3040	1	RH Scale Bracket (RH in 1/2" & 1/4" mode) with screws (3110)
3050	1	LH Scale Bracket (LH in 1/2" & 1/4" mode) with screws (3110)
3060	1	RH Scale Assembly (RH in 1/2" & 1/4" mode) with screws (3110)
3060M	1	RH Scale Assembly (RH in 12mm mode) with screws (3110)
3070	1	LH Scale Assembly (LH in 1/2" & 1/4" mode) with screws (3110)
3070M	1	LH Scale Assembly (LH in 12mm mode) with screws (3110)
3080	2	Fence Knobs
3090	2	Fence Knob Bolts
3100	2	Fence Knob Wavy Washer
3110	4	Set Screws for Scale Bar and Bracket
3120	1	Template Pin with Tie (3130)
3130	1	Template Pin Tie
3140	4	Template Bar Glides
3149	1	F2 VGS Set complete, inch (contains 709V, 711V, 713V, 716V)
3149M	1	F2M VGS Set complete, metric (contains 711V, 713V, 716V)
3156	1	Allen Wrench for Set Screws
3157	1	VGS Box
3158	1	VGS Box Liner
3170	1	User Guide, combined inch & metric
700V	1	VGS Holder (2 pieces)
701V	1	VGS Holder
709V	1	VGS Bush for 1/4" Comb - for "Inch" template only
711V	1	VGS Bush for 5/16"[8mm] Comb
713V	1	VGS Bush for 3/8"[10mm] Comb
716V	1	VGS Bush for 1/2"[12mm] Comb
730V	1	Pin Wrench for VGS
741V	8	Nylon Thread-Inserts for VGS (on tree)

F2 & F2M PARTS ILLUSTRATION

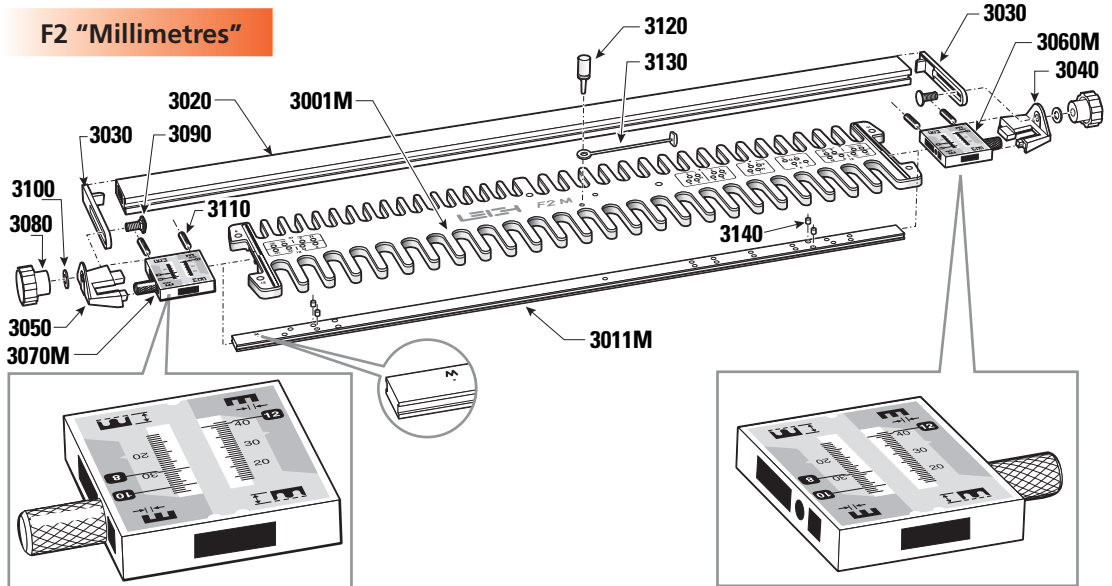
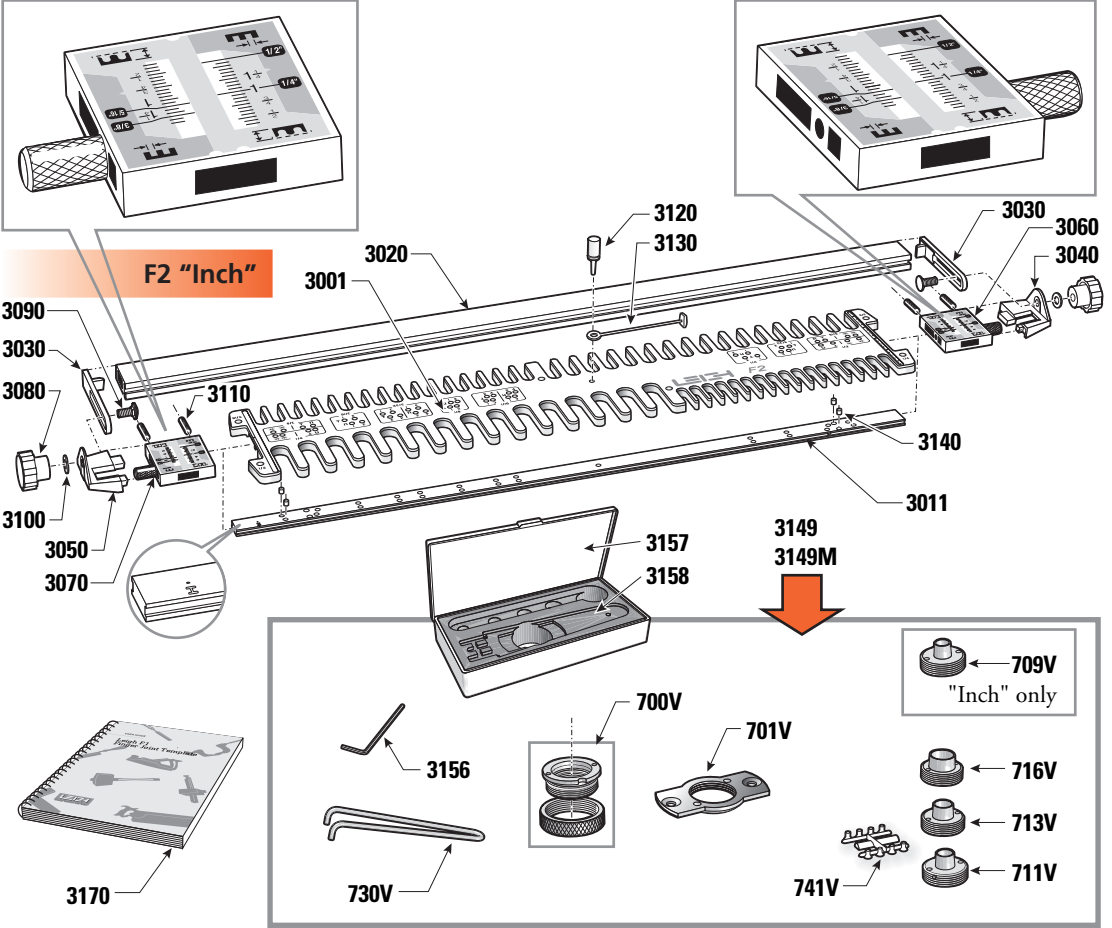

## F1600 &amp; F1600M PARTS LIST

For quick reference, record your  
template's serial number here.

When ordering parts, please quote the Template model (inch or metric), serial number, part number, part description and quantity required.

PART NUMBER	QUANTITY PER TEMPLATE	PART DESCRIPTION
3300	1	"Inch" Template with decals
3300M	1	"Metric" Template with decals
3310	1	"Inch" Template Bar with glides (3140)
3310M	1	"Metric" Template Bar with glides (3140)
3360	1	RH Scale Assembly (RH in 1/4" & 8mm mode)
3370	1	LH Scale Assembly (LH in 1/4" & 8mm mode)
3120	1	Template Pin with Tie (3130)
3130	1	Template Pin Tie
3140	4	Template Bar Glides
3316	1	F1600 VGS Set complete, inch (contains 709V, 713V, 716V)
3149M	1	F1600M VGS Set complete, metric (contains 711V, 713V, 716V)
3157	1	VGS Box
3158	1	VGS Box Liner
3170	1	User Guide, combined inch & metric
7210	2	Scale Nut
7215	2	Scale Washer
7220	2	Scale Wedge
7225	2	Scale Lock Screw #8-32
7250	2	Scale Thumbscrew
7255	2	Nylon Flat Washer 1 <sup>3</sup> / <sub>64</sub> " x 7/ <sub>16</sub> " x .062"
700V	1	VGS Holder (2 pieces)
701V	1	VGS Holder
709V	1	VGS Bush for 1/4" Comb - for "Inch" template only
711V	1	VGS Bush for 8mm Comb - for "metric" template only
713V	1	VGS Bush for 3/8"[10mm] Comb
716V	1	VGS Bush for 1/2"[12mm] Comb
730V	1	Pin Wrench for VGS
741V	8	Nylon Thread-Inserts for VGS (on tree)

F1600 & F1600M PARTS ILLUSTRATION

F1600 "Inch"

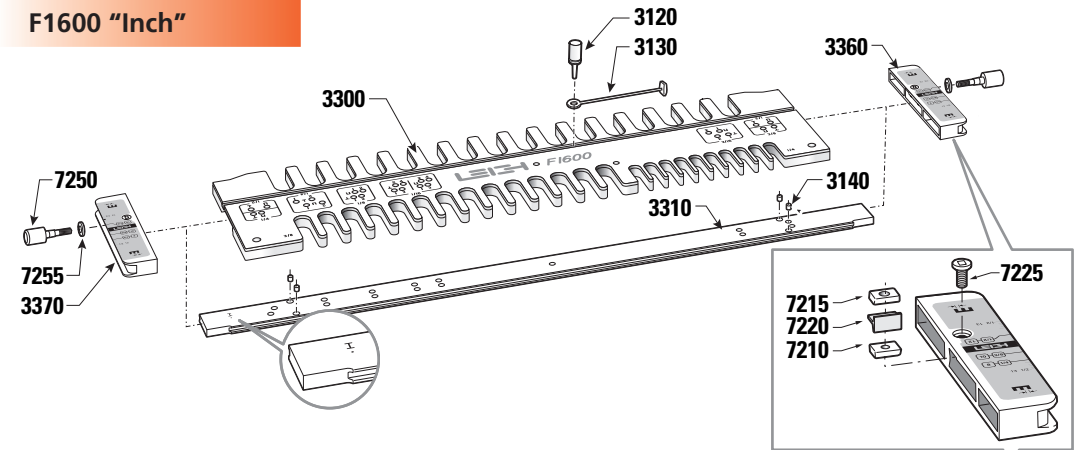

F1600M "Millimetres"

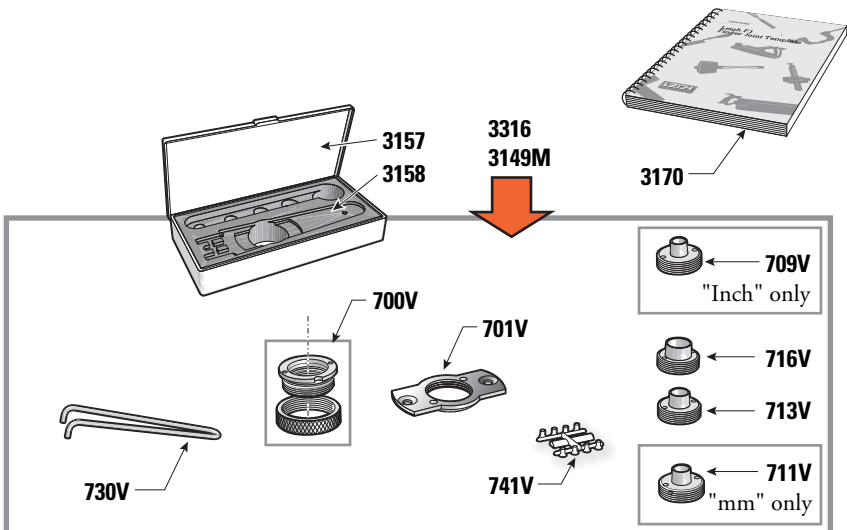
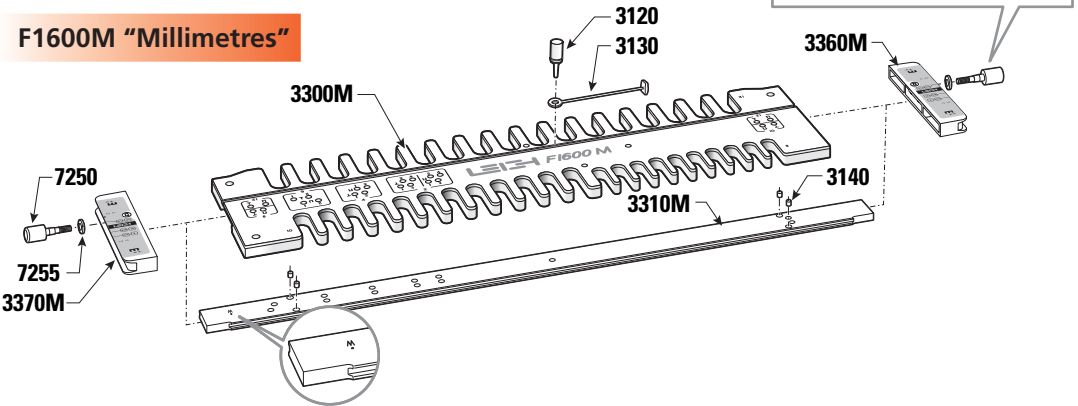





## *F2, F1600 APPENDIX IV*

# **Customer Support**

### ***Our Commitment to You***

*At Leigh Industries we take pride in our commitment to provide excellence in customer service and support. We hope your use of the Leigh D1600 will be enjoyable, rewarding and most of all, trouble free. We hope this User Guide will provide you with the answers to any questions you may have.*

*If this is not the case, please feel free to contact our technical support staff or our distributor in your country by any of the means listed in this chapter.*

**Manufacturer - Canada & USA**

Leigh Industries Ltd. (EST. 1981)      Toll Free: 1-800-663-8932  
 P.O. Box 357,      Telephone: (604) 464-2700  
 1615 Industrial Ave.,      Facsimile: (604) 464-7404  
 Port Coquitlam, B.C.,      \*E-mail: leigh@leighjigs.com  
 Canada, V3C 4K6      Website: www.leighjigs.com

\*Email can be useful, but technical queries usually raise queries from us. So the telephone (if possible) is a much quicker and more convenient way to get those queries answered; either directly to Leigh (toll-free in North America) or to your national distributor. ... Thanks!

**Distributors****Australia & New Zealand**

Mik International  
 Post: Box 70 Burnside SA 5066  
 Australia  
 Store: 27 Magill Road, Stepney, SA  
 5069 Australia  
 Tel:+61 8 8363 4666  
 Fax:+61 8 8362 3444  
 Email: inquiries@mik.com.au  
 Web:www.mik.com.au

**Germany, Austria, Switzerland**

Hacker GMBH  
 Holzbearbeitungsmaschinen  
 Traberhofstraße 103  
 D-83026 Rosenheim  
 Deutschland  
 Tel:08031 269650  
 Fax:08031 68221  
 Web:www.leigh.de

**Israel**

Duet Wood Art  
 PO Box 1829  
 Pardes Hana 37100, Israel  
 Tel:972-4-6376754  
 Tel:972-4-6377071  
 Fax:972-4-6231980  
 Email: leigh@leighjigs.co.il  
 Web:www.leighjigs.co.il

**Italy**

Ferrari Macchine Legno S.R.L.  
 Via Gallarate, 74-7820019 Sestimo  
 Milanese (MI), Italy  
 Tel:+39 02 33501095  
 Fax:+39 02 33500527  
 Email: info@ferrarimacchine.com  
 Web:www.ferrarimacchine.com

**South Africa**

Hardware Centre  
 Post: PO Box 4059, Randburg,  
 2125, South Africa  
 Store: Shop 8 Homeworld Centre  
 Cnr Hans Strijdom & C.R Swart  
 Drives, Randburg, Johannesburg  
 Tel:(011) 791-0844/46  
 Fax:(011) 791-0850  
 Email: info@hardwarecentre.co.za  
 Web:www.hardwarecentre.co.za

**Sweden**

Toolbox Sweden AB  
 Horla Heden 1  
 SE 441 93 Alingsås, Sweden  
 Tel:0322-67 04 40  
 Fax:0322-67 04 49  
 Email: info@toolboxsweden.se  
 Web:www.toolboxsweden.se

**United Kingdom & Eire**

BriMarc Associates Limited  
 Nick Lowe House  
 Unit 20A Harriott Drive  
 Heathcote Industrial Estate  
 Warwick CV34 6TJ, England  
 Tel:0845 330 9100  
 Tel:+44(0)1926 884440 (Intl.)  
 Fax:01926 884444  
 Web:www.brimarc.com

**Japan**

Off Corporation Inc.  
 323-1 Shimizu-Yanbara  
 Shizuoka City, Japan 424-0002  
 Tel:81-543-67-6511  
 Fax:81-543-67-6515  
 Email: craft@off.co.jp  
 Web:www.off.co.jp

**Korea**

Leigh Korea (formerly Woodworking  
 Academy)  
 #102, Kyunggi Praza, 36-5,  
 NeungPyung-Ri  
 Opo-Eup, Kwngju-Si, Kyunggi-do,  
 Korea  
 Tel:+82-(0)31-768-3303  
 Fax:+82-(0)31-768-3376  
 Email: smgi@paran.com  
 Web:  
 www.woodworkingacademy.com

**LEIGH**  
 Joining Tradition with Today

**LEIGH INDUSTRIES LTD.**  
*Manufacturers of Precision  
 Woodworking Tools*

© 1997 Leigh Industries Ltd. All rights reserved.  
 No part of this publication may be reproduced, stored  
 in a retrieval system, or transmitted in any form or  
 by any means, electronic, mechanical, recording, or  
 otherwise, without the prior written permission of  
 Leigh Industries Ltd. 02/06