

Guidebush Selection

The correct guidebush is the vital link between the router and your Leigh Jig. It precisely steers the router. Where possible, always use the Leigh system to ensure correct bush length and precise diameter for accurate results.



Guidebush Selection

Only one size of guidebush is used with the Leigh D1600 Jig*: $\frac{7}{16}$ " [11,1mm] O.D. Bush barrel length ① from base of router should be $\frac{1}{4}$ - $\frac{9}{32}$ " [6 - 7mm].

Use the $\frac{7}{16}$ " [11,1mm] guidebush for all half-blind and through dovetailing with $\frac{1}{4}$ " [6,35mm] or 8mm shank cutters: i.e., dovetail cutter Nos. 50-8, 50, 60-8, 60, 70-8, 70, 75-8, 75, 80-8, 80, 101-8, 101, 112-8, 112, 120-8, 120, 128-8, 128, and straight cutter Nos. 140-8 and 140.

Here are two types of Leigh guidebush and five Leigh adapters. Use the chart on page 104 to select the adaptor and/or guidebush required for your router. The 711TP comes standard with your D1600.

**Except for sliding dovetails (see page 113).*

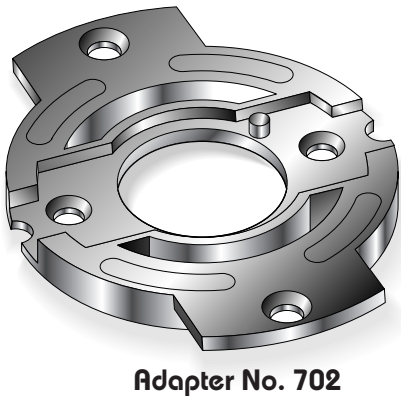
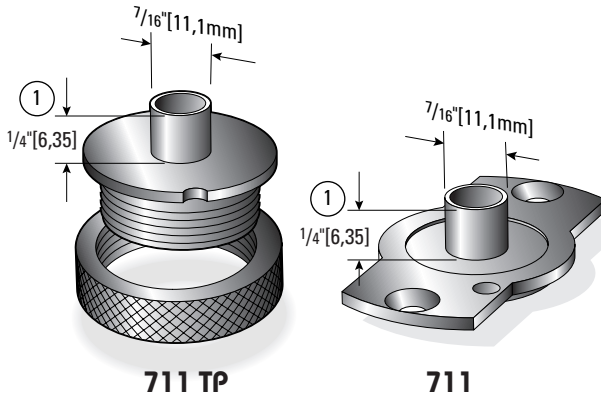

Adapter No. 702

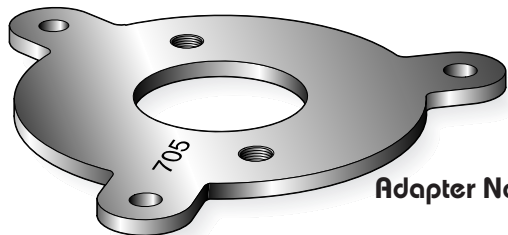

Adapter No. 705



Adapter No. 706

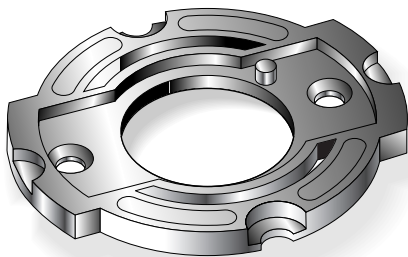

Adapter No. 703

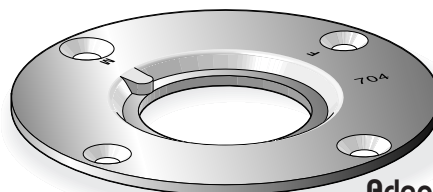

Adapter No. 704

The Leigh 711TP (TP stands for Two Part) fits directly to many routers.

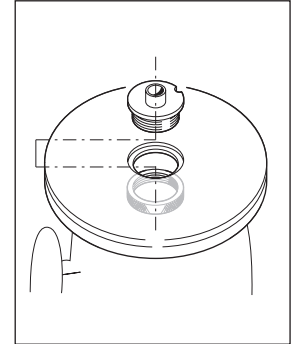

The Leigh 711 guidebush fits directly to some routers using the screws that come with the router.

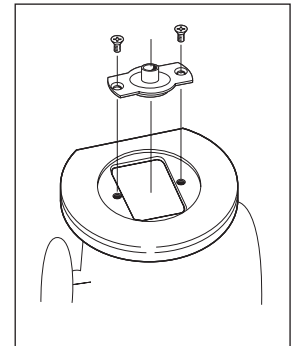

Leigh universal adapters fit to a wide range of plunge routers and generally accept the Leigh 711 bushes or 711TP bushes.

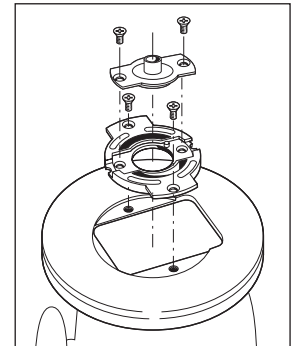
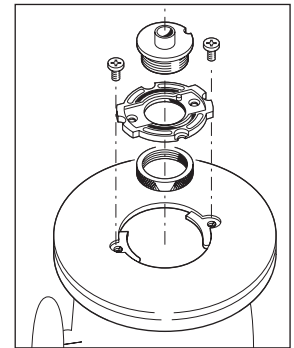

Check the make and model of your router in the left hand column. Where possible always order the Leigh adaptors and guidebushes (in red) which are specially designed for use on Leigh jigs. Other adaptors or guidebushes must be purchased from the manufacturer's own distributor.

ROUTER MAKER	ROUTER MODEL	LEIGH OR ROUTER MAKER'S ADAPTOR NO.	7/16" [11,1mm] OUTSIDE DIA. GUIDE BUSH NO.	METHOD OF ATTACHMENT
AEG	OFE 710 in plunge base	No adaptor required	711	Screws incl. w/router
	OFSE 2000	703	711	◆
ATLAS COPCO	OFE 710 in plunge base, OFE 1000	No adaptor required	711	Screws incl. w/router
	OFSE 2000	703	711	◆
AXMINSTER WHITE	AW635R	No adaptor required	711	Screws incl. w/router
	AW127R	Adaptor supplied w/router	711	Screws incl. w/router
BLACK & DECKER	All Professional, HD 1250, RP400K	No adaptor required	711TP	Threaded nut included
	6200	720673-00	711TP	2 screws req'd. 249412-20
	SR100, 7AEE, KW780 series	No adaptor required	711	Screws incl. w/router
BOSCH	90140, 90098, 90088		82855	Screws included
	90085, 90150, 90300, 90303, 90305, 91264	No adaptor required	82859	Screws included
	1600, 1601, 1602, 1603, 1604, 1606, B1350	2 610 906 290	711TP	Threaded nut included
	1613, 1613EVS, 1613AEVS, 1614, 1614EVS, 1617, 1617EVS, 1618EVS, 1619EVS, B1450, POF800ACE, GOF900ACE, GOF1300ACE, GOF2000CE	No adaptor required (RA1100 required for VGS)	RA1107	No screws required
	16111, 16111 EVS, 1615, 1615 EVS, B1550 GOF1600, GOF1700ACE	702	711	◆
CASALS	FT750, FT 1000E, FT2000E	703	711	◆
CMT	1E	702R	711	◆
CRAFTSMAN (SEARS)	All non-plunge models	No adaptor required	Set of 3 bushes from Sears USA order no.25082 (stamped steel) or 25090 (plastic). Set of 3 bushes from Sears Canada order no.092-970-704	Screws incl. w/set
	135275070 Plunge		See Skill 1823 or 1835	
	Other plunge models	702	711	◆
DEWALT	DW610	No adaptor required	711TP	Threaded nut included
	DW613	No adaptor required	711	Screws incl. w/router
	DW614, DW615, DW621	North America Only	711TP	Threaded nut included
	DW624, DW625 and DW626	Adaptor supplied w/router	711TP	Threaded nut included
	DW621K and DW626 outside N. America	706	711	◆
	DW625 Type 1, 2 & 3 outside N. America	702	711	◆
EINHELL	DW625 Type 4 outside N. America, DW625EK	702R	711	◆
	EOF 850 SP, OF-G 1100E	No adaptor required	711	Screws incl. w/router
ELU	OF15, OF15E, OF97, OF97E	706	711	◆
	MOF68, MOF69, MOF96, MOF96E	No adaptor required	711	Screws incl. w/router
	MOF131, MOF177 Type 1, 2 & 3	702	711	◆
	MOF177 Type 4, MOF177EK	702R	711	◆
	2720, 2721, 3328	No adaptor required	711TP	Threaded nut included
	3303, 3304	EO9600 or 761 270-00	711TP	Threaded nut included
	3337, 3338, 3339	702	711	◆
FEIN	RT1800	Adaptor supplied w/router	711TP	◆
FESTOOL	OF1E, OF2E, OF650, OF900E, OF1000, OF1010E	704	711TP	Threaded nut included
	OF2000, OF2000E	705	711	◆
	OF1400	with Festool Adaptor	711TP	Threaded nut included
FLEX	All	No adaptor required	711TP	Threaded nut included
FREUD	FT2000	703	711	◆
HITACHI	TR8, TR12, FMB, MB, M12 Series	703	711	◆
HOLZ-HER	2355, 2356	No adaptor required	711	Screws incl. w/router
	2365	702	711	◆
ISKRA	MR808A Series	No adaptor required	711	Screws incl. w/router
JEFSON	7412	703	711	◆
KANGO	OF808	No adaptor required	711	Screws incl. w/router
KRESS	OF690 IE Series	No adaptor required	711	Screws incl. w/router
MAFELL	LOG5E	702 ■	711	◆
MAKITA	3600, 3606, 3608, 3612, 3612B, 3612BR	703	711	◆
	3612C N. America, 3620, 3621		Contact your National Leigh distributor	
	3612C Europe Ok Fit Base			
	3601B	321 493-1	711TP	Threaded nut included
	RP0910, RP1100C	706	711	◆
METABO	RF1100, RF1101, RD1100, RD1101, RP1101	No adaptor required	711TP	Threaded nut included
	OF1612, OFE1812	704	711TP	Threaded nut included
MILWAUKEE	All	No adaptor required	49-54-0520	Screws included
PERLES	OF808 Series, OFE 6990	No adaptor required	711	Screws incl. w/router
PORTERCABLE(Rockwell)	All	No adaptor required	711TP	Threaded nut included
POWER DEVIL	All	No adaptor required	711	Screws incl. w/router
RYOBI	R30, R50, R150, R151, RE155, R161	703	711	◆
	R500, R501, R502		711	◆
	R600, R601, RE600, RE601	702	711	◆
	R160, R165, R170, R175, RE175, R180, R185	706	711	◆
SCHEER	HM9, HM14, HM14-12, HM18, HM18-E	No adaptor required ●	711	Screws incl. w/router
SKIL	1823 or 1835	91803	711TP	Threaded nut included
	All others	No adaptor required	11592	Nut 11587
STANLEY	All		See Bosch Distributor	
STAYER	PR50 Series	No adaptor required	711	Screws incl. w/router
TREND (FELLISATI)	T5	No adaptor required	711	Screws incl. w/router
	T9	Adaptor supplied w/router		
WEGOMA	OF850 Series	No adaptor required	711	Screws incl. w/router

Note: Ideal barrel depth is 1/4" to 9/32" (6mm to 7mm) below the router base. Other manufacturers' guidebushes may require careful cutting to length.
 ◆ Guidebush mounting screws are provided with adaptor and adaptor mounting screws are provided with router.
 ▼ 5/8" (15.8mm) O.D. guidebushes are used only with 1/2" (12.7mm) Shank router bits. ■ MAPELL - Rework the adaptor slightly. ● SCHEER - Rework the router base slightly.

